

IMPORTANT SAFETY INSTRUCTIONS

When using electrical appliances, especially when children are present, basic safety instructions should always be followed, including the following:

Polythene bags over product or package may be dangerous. To avoid danger of suffocation, keep this wrapper away from babies and children.

DANGER – When the facial sauna is used in a bathroom, unplug it after use since the proximity of water presents a hazard even when the unit is switched off.

WARNING – Do not use the facial sauna in or near bathtubs, showers or other vessels containing water.



- Do not immerse the facial sauna in water or other liquids.
- Do not reach for an appliance that has fallen into water. Unplug immediately.
- Take care to avoid contact between the hot surfaces of the appliances and the skin, paying particular attention to the face, neck and hands.
- The facial sauna set is not intended for use by persons (including children) with reduced physical, sensory or medical capabilities, or lack of experience or knowledge, unless they are supervised and have been given instruction concerning the use of the appliances by persons responsible for their safety.
- Children should be supervised to ensure that they do not play with the appliance.

IMPORTANT – Always unplug the appliances when not in use or before cleaning.

- Do not leave unattended when plugged in on switched on. Do not place on any heat sensitive surface and always allow to cool before storing away.
- Do not use any attachments other than those supplied by Conair Australia Pty Ltd.
- Use the appliances only for their intended use as described within this instruction booklet.
- These appliances are not intended for commercial use.

- Never drop or insert any object into any opening of the appliances.
- Ensure the facial sauna is switched off before plugging into a suitable power outlet.
- Only use the facial sauna on a hard, flat surface.
- Always unplug the facial sauna when not in use and when filling, emptying, cleaning or moving the appliance.
- Take care when emptying the facial sauna as hot water may still remain in the reservoir. Ensure the appliance has cooled down and is switched off before emptying or moving the appliance.
- Ensure your hands are dry before touching the control switch or plug of the facial sauna.
- Do not add boiling or steaming water into the facial sauna. Use cool or warm water only.
- Take care not to spill any water onto the control switch of the facial sauna. Only use the water cylinder when pouring water into the reservoir.
- Never use the facial sauna without water in the reservoir.
- Never use additives such as salt, perfume or dye, use clean water only.
- Never use the facial sauna without the comfort shaped mask.
- Never place your face too close to the facial sauna in one position, as this could cause scalding.
- Do not use outdoors or operate where aerosol (spray) products are being used or where oxygen is being administered.
- Do not operate the facial sauna under a blanket or pillow. Excessive heating can occur and cause fire, electric shock or injury.
- Keep the facial sauna power cord away from heated surfaces.
- Do not use an extension cord with the facial sauna.
- Do not carry the facial sauna by the supply cord or use cord as a handle.
- Do not use this facial sauna if the supply cord is damaged. In the event of damage, discontinue use and contact your dealer for instructions on returning it for examination or exchange.

- After use do not wrap the cord around the facial sauna, as in time this may cause the cord to fracture. Coil cord loosely beside the facial sauna.
- Always ensure that the voltage to be used corresponds to the voltage marked on the facial sauna.
- For additional protection, the installation of a residual current device (RCD) with a rated operating current not exceeding 30mA is advisable in the electrical current circuit supplying the bathroom. Ask your installer for advice.
- The facial sauna should be cleaned after each use, to avoid the accumulation of grease and other residues.

SAVE THESE INSTRUCTIONS OPERATING INSTRUCTIONS

If you have any skin condition, sensitivity to heat, or other health issues or questions, including those relating to use of this product while undergoing any treatments or taking any medications, please consult with a physician before use.

This product should not be used in the following cases: Tuberculosis, diabetes, benign and malignant tumors, inflammations of the skin, phlebitis and thrombosis, open and fresh wounds, bruises, broken skin or varicose veins.

INSTRUCTIONS FOR USING YOUR FACIAL SAUNA

Before beginning, cleanse your face, following your daily care routine. Lightly pat your favorite moisturizer or eye cream around the eye area.

GETTING STARTED

Use for facial cleansing with both the warm steam and cool mist features.

- Lift facial cone away from the base.
- Lift upper housing in front to access water chambers. The housing is hinged and should lift backward from the front.
- Your facial sauna has two water chambers, one for warmsteam, the other for cool mist. To fill the chambers with water, first unscrew the cap on the warm steam chamber and then lift off the lid of the cool mist chamber. Fill the warm steam chamber with approximately 2 cupsful of water, or until the water has reached the maximum fill line (“MAX”) in the cool mist chamber.
- Replace both cool mist lid and warm steam screw cap and close hinged lid.
- Place facial cone over unit.
- Plug unit.

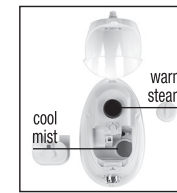

USING YOUR FACIAL STEAMING UNIT

- Your Facial Sauna includes one detachable cone.

USING THE WARM STEAM FEATURE

- For sensitive skin: For sensitive skin, be careful not to position your face too close to the steam or for long periods of time. Check your skin often to prevent skin irritation.
- Set timer; you can set your treatment times in increments of 3, 6, 9, 12 or 15 minutes.
- Turn switch to HOT position.
- The light next to “HOT” should now be lighted. This indicates that the sauna is on and in use for the designated warm steam function.
- Allow 3 minutes for steam to generate.
- When the set time expires for the warm steam feature, the sauna will shut off automatically.
- After completion of a timed steam treatment, you may repeat the above steps for another timed treatment, or close pores with the cool mist feature. Before closing pores, wipe away loose dirt from pores.

USING THE COOL MIST FEATURE

- Set timer; you can set your treatment times in increments of 3, 6, 9, 12 or 15 minutes.
- Turn switch to COOL Position.
- The light next to “COOL” should now be lighted. This indicates that the unit is on and in use for the designated Cool Mist function.
- Allow 2 seconds for water to change over from warm steam to cool mist.
- Cool mist can be used for a period of up to 10–15 minutes. Unit will shut off automatically when water level is lower than water sensor or timed usage period has expired.
- Pat face dry with cloth. Apply your favorite moisturizer.

SPECIAL PAMPERING TIPS FOR DELICATE AREAS

THE EYE AREA

- Give special care to the eye area during your personal facial by lightly massaging additional moisturizer or eye cream on eyelids and under your eyes before you begin.

THE NECK AND THROAT

- Apply your favorite moisturizer to your entire face.
- Mist your face for only 5 minutes, following Instructions for Using Your Facial Sauna.
- Tilt your head backward so your throat is approximately 2 inches from the facial mask.
- Mist your throat for 2 minutes. For best results, accelerate moisturizing process by gently turning neck from side to side.

SPECIAL USES

- Consult your physician or dermatologist for instructions on how to best use the Facial Sauna for your specific condition.

USER MAINTENANCE INSTRUCTIONS

CARING FOR YOUR FACIAL SAUNA

After completing your facial:

- Always turn off and unplug your Facial Sauna from the electrical outlet before cleaning it.
- Let cool, then empty excess water and wipe dry the interior of the facial mask and rim around the opening.
- Wipe the base with a clean, damp cloth, then polish lightly with a dry one. NEVER IMMERSER THE FACIAL SAUNA IN WATER.
- Do not attempt to repair the appliance yourself. Return it to the place of purchase with sales receipt.

CAUTION

Never allow the power supply cord to be pulled, twisted or severely bent. Never wrap the cord tightly around the unit. Damage will occur at the high flex point of entry into the unit, causing it to rupture and short circuit. Inspect the cord frequently for damage. **Stop use immediately if damage is visible or unit stops or operates intermittently.**

The Facial Sauna is for household use only.

STORAGE – Important

When not in use, your unit should be disconnected and stored in a safe, dry location, out of reach of children. Do not wrap line cord around unit. Allow the cord to hang or lie loose and straight at the point of entry into the unit.

LIMITED ONE YEAR WARRANTY

This product is subject to the express warranty given on the warranty card included with the product, as may be amended by reference to and in accordance with the terms of the warranty cards displayed on Conair website www.conairaustralia.com.au

To make a warranty claim you must retain your proof of purchase. Further details can be found at www.conairaustralia.com.au and click on 'customer service'.

CONAIR®

©2014 Conair Australia Pty Ltd.
Suite 101, 18 Rodborough Rd
Frenchs Forest NSW, 2086
Australia
Customer Service Hotline Australia: 1800 650 263
New Zealand: 0800 266 247
E-mail us at: aus_info@conair.com
www.conairaustralia.com.au

true glow

Warm Steam/Cool Mist
Facial Sauna

